

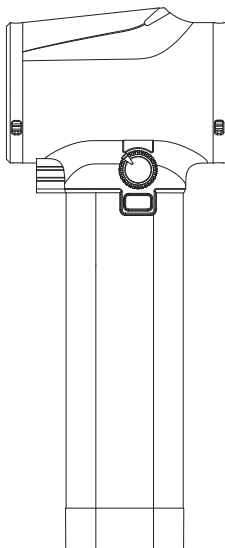

TURBOFAN

user's manual



I. Product introduction

[1] Air outlet

[2] LED lighting

[3] Infinitely variable speed knob

[4] Turbo gear button

[5] DC charging interface

[6] Power switch

[7] LED lighting power switch

[8] Air inlet

[9] Multi-function indicator light

[10] DC charger

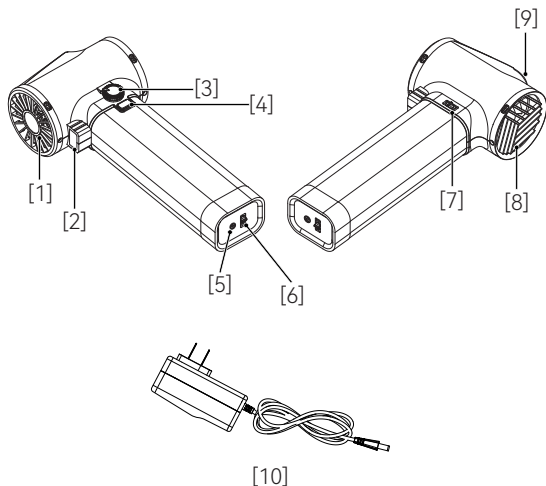

II. Product use

A. Blow drying function

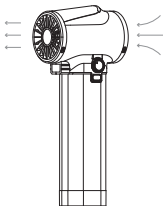

B. Operation method

Turn the bottom power switch to ON to enter standby mode, and turn it to OFF to turn off the machine. The power level will be displayed when the machine is turned on, and the machine will enter standby mode.

*After turning on the power, if the knob is not in the MIN position, the motor is in a locked state and a "beep-beep-beep" prompt sound is emitted. The stepless speed change and Turbo gear functions will not work properly. Turn the knob to the MIN position to release the motor lock. The gear can be adjusted normally using the lever, and the Turbo gear can also be used normally.

When the device is powered on and the above conditions are met:

- Use the stepless speed knob to adjust the wind speed. MIN is the lowest wind speed, and MAX is the highest wind speed except Turbo.
- Press and hold the Turbo gear button to use the Turbo gear. The top light shows the current energy. The energy bar is continuously consumed during use. Release the Turbo gear button and the energy bar starts to store energy. You can use the Turbo gear again during the energy storage process.
- Push the lighting switch on the back of the product to ON to turn on the light, and push it to OFF to turn off the light.

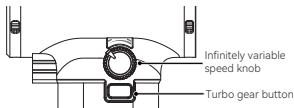
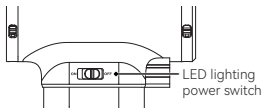

C.Indicator light

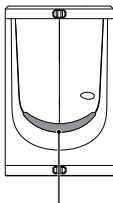

Multi-function indicator light

Turbo gear indicator light display		Description
All show purple light		Energy has been consumed
Not all cyan lights are displayed		storing energy
All show cyan light		Energy storage completed
When the indicator light shows the battery level		Description
Green light always on		60%~100%
Orange light always on		30%~60%
Red light always on		10%~30%
Red light flashing		0%~10%
Indicator light display during charging		Description
Red light flashing		10%~30%
Orange light flashing		30%~60%
Green light flashing		60%~99%
Green light is on		100%

D.Charging

Before using for the first time, please make sure to fully charge the battery before using it to avoid affecting the battery performance.

Make sure the power is turned off when charging. (This product does not support charging and power on at the same time)

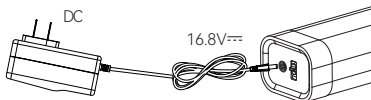

E.Product parameters

Product name: Turbofan

Model: TF64A2

Charging interface: DC

Rated input: 16.8V==

Operating temperature range: 0°C~+40°C

Storage temperature range: -20°C~+60°C

Charging time: about 3 hours

Product size: 282×114.5×73mm

Product weight: about 827g

Packing list:

Main unit × 1; DC charger × 1; Instruction manual × 1

Notice:

Please read this manual carefully before using the product and keep it in a safe place. To avoid the risk of fire, property damage, and personal injury, be sure to follow the following safety precautions:

1. Do not use with wet hands.
2. This product is prohibited from being exposed to splashing water or immersion in water.
3. It is prohibited to block the air inlet and blowing outlet when the product is working.
4. It is prohibited to insert foreign objects into the air blower and air inlet.
5. It is prohibited to place this product near a heat source (stove or heater, etc.) or in a car on a hot day.
6. Do not use near petroleum gas or other flammable products (such as volatile agents, paint thinners, sprays, etc.), otherwise it may cause an explosion or fire.
7. It is strictly prohibited to drop or collide, as it may cause damage and cause abnormal operation. If it cannot be used normally, please contact after-sales service in time.
8. Please do not pull, twist, squeeze or modify the charging cable with force. If the charging cable is abnormally hot or damaged, please stop using the charging cable immediately.
9. If the product produces abnormal noise, odor, high temperature, or abnormal fan blade rotation, please stop using it immediately.
10. Please do not disassemble the entire product. If it is accidentally disassembled and causes abnormal operation, please contact after-sales service to send it back.

III. Instructions for use

Use and storage:

1. The air output from this product is cold air. When using, please keep your hair away from the blower and air inlet to avoid hair being inhaled.
2. Please do not blow the air towards the eyes, ears, mouth and other human organs during use.
3. Do not leave the product while using it.
4. Please do not store this product where children and pets can reach it.
5. Do not store this product in a humid environment or an environment prone to splashing water (such as near a bathtub, shower room, washbasin or other water container).
6. Do not use this product in an environment where the temperature is too high or too low.
7. Store in a well-ventilated, dry place away from direct sunlight.

Care and maintenance:

1. This product is not waterproof. Please do not use cleaning liquids such as alcohol, nail polish remover or detergent to clean this product. It is recommended to use a clean soft cloth to clean the product.
2. Regularly remove attachments from the air blower and air inlet.
3. Do not press or rub the blower and air inlet with nails or sharp objects.
4. Do not overcharge or discharge the battery, otherwise it will cause damage to the battery core.

Things to note when discarding the product:

The battery used in this product is a recyclable resource. When discarding, please hand it over to a professional organization that can recycle rechargeable batteries. Batteries must be removed from the appliance before disposal; the appliance must be de-energized when removing batteries; batteries must be disposed of safely.

Removal steps:

1. Use professional tools to open the switch cover:
2. Pull out the battery lead terminal from the motherboard;
3. Use professional iron scissors to cut open the casing and take out the battery.

Disclaimer:

Thank you for choosing this product. The content mentioned in this article is related to your safety, legal rights and responsibilities. Please read it carefully and follow the instructions to set up and use this product correctly. Failure to follow the instructions and precautions in this article may cause injury to you and those around you, and may damage this product or surrounding products.

Any illegal use by any user is prohibited. Users will be responsible for all actions of purchasing and using products. For this product, the company does not bear all risks and responsibilities (including direct or indirect third-party losses) during the debugging and use of this product by the end customer.

Our company will not provide any services for any products obtained from abnormal channels or for unknown purposes.